

CONVEYOR BELT OPTIONS

Know The Difference

ENDLESS BELT (READY TO FIT)

A finished length of conveyor belt with a hot (vulcanised) splice forming a continuous loop.



Note: Customer provides endless length measurement.

PREPARED BELT (SPliced & READY FOR VULCANISING)

A measured length of conveyor belt with overlapping, spliced prepared ends ready for hot or cold splicing (vulcanising).

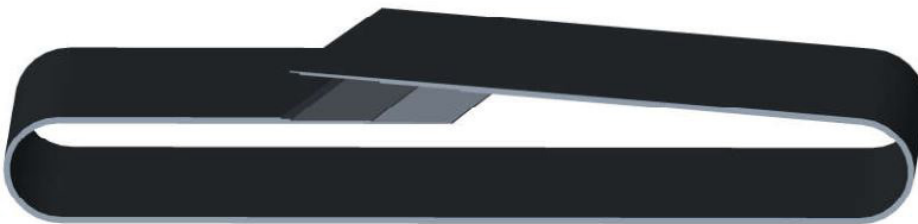

Note: Customer provides endless length measurement but does not need to add anything to their measurement to allow for the splice overlap as Smiley Monroe will account for the extra material.

CUT LENGTH BELT (READY TO PREPARE)

A length of conveyor belt with square ends that includes a length allowance (overlap) for preparing and hot splicing (vulcanising).



Note: Customer provides endless length measurement but does not need to add anything to their measurement to allow for the splice overlap as Smiley Monroe will account for the extra material. Or customers can provide head and tail pulley diameters and centre to centre distance between pulleys.

V1 09/18

Head Office & Production Centre
Smiley Monroe Ltd
23 Ferguson Drive
Knockmore Hill Industrial Park
Lisburn, BT28 2EX
Northern Ireland, United Kingdom

T. +44 (0) 28 9267 3777
E. hello@smileymonroe.com

SMILEY[®]
MONROE

CONVEYOR BELT OPTIONS

Know The Difference

MECHANICALLY FASTENED (SCREW IN)

Zip Clip® - a mechanically fastened replacement conveyor belt with a secure screw-in connecting pin and a polyurethane seal.



Note: Customers should order a Zip Clip® belt that is the same width, length and specification as the Endless belt you want to replace.

MECHANICALLY FASTENED (PUSH IN)

Zip Clip® - a mechanically fastened replacement conveyor belt with an easy-to-fit push-in connecting pin and 2 zinc plated steel retaining collars which provides extra peace of mind by ensuring the pin can't become loose whilst the conveyor belt is running.

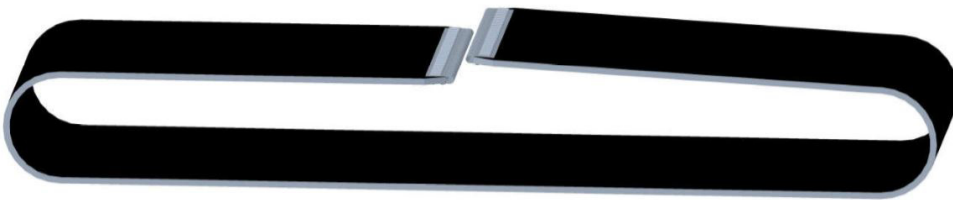

Note: Customers should order a Zip Clip® belt that is the same width, length and specification as the Endless belt you want to replace.

Head Office & Production Centre
Smiley Monroe Ltd
23 Ferguson Drive
Knockmore Hill Industrial Park
Lisburn, BT28 2EX
Northern Ireland, United Kingdom

T. +44 (0) 28 9267 3777
E. hello@smileymonroe.com

SMILEY®
MONROE