

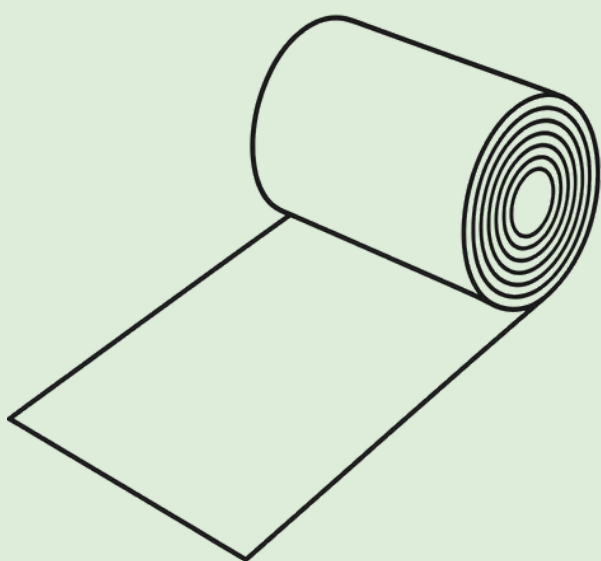

# ***CUT LENGTH BELTS***



# ***CUT LENGTH BELTS***

**AT SMILEY MONROE, WE SUPPLY CUT LENGTH BELTS DESIGNED FOR CUSTOMERS WHO PREFER TO PERFORM THEIR OWN ON-SITE SPLICING. THESE BELTS ARE MANUFACTURED TO THE HIGHEST STANDARDS, INCLUDING DIN 22102, AND ARE PREPARED WITH A PRECISE LENGTH PLUS THE REQUIRED OVERLAP FOR HOT VULCANISED JOINING.**

---

Each Cut Length Belt is supplied with square-cut ends and includes a length allowance for splicing, meaning no additional measurement is required from the customer. Simply supply the endless length measurement — or alternatively, head and tail pulley diameters with the centre-to-centre distance — and we'll do the rest.

## WHY CUT LENGTH BELTS?



Custom Prepared for On-Site Splicing.



Flexibility in Ordering.



High-Quality Materials & Standards. Built to DIN 22102 with consistent quality.



Compatibility Across Applications. Available in EP Multi-ply, ToughFlex®, Ripstop, and Fabric Breaker — with oil, heat, fire, and frost-resistant cover options.



## ***PREPARED BELT***

### **SPLICED AND READY FOR VULCANISING**

A measured length of conveyor belt with overlapping, spliced prepared ends ready for hot or cold splicing (vulcanising).

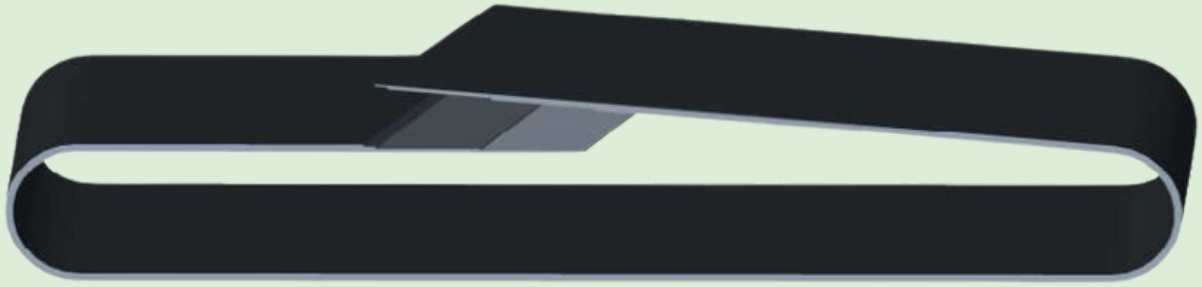

## ***CUT LENGTH BELT***

### **READY TO PREPARE**

A length of conveyor belt with square ends that includes a length allowance (overlap) for preparing and hot splicing (vulcanising).



## ***CONSISTENT QUALITY***

Across our three production facilities, Smiley Monroe belts are manufactured to the latest DIN 22102 and ISO standards. We pride ourselves on our consistent quality and offer a 12-month or 1000-hour warranty across all our belts.

*For the last ten years, our warranty rate has stayed below 0.2%. Across more than 20,000 belts annually, that is a stat we are pretty proud of.*

---

## ***GLOBAL SUPPLY***

Being close to our customers is at the heart of what we do. With global production facilities across the UK, USA and India, we offer our global customers speedy response rates, short lead times and just-in-time delivery. With a large variety of stock options available, we always have you covered regardless of your machine and your application.



## **CONTACT US**

### **GLOBAL HQ**

**Smiley Monroe Ltd**  
23 Ferguson Drive  
Knockmore Hill Industrial Park  
Lisburn  
BT28 2EX  
Northern Ireland  
United Kingdom

+44 (0) 28 9267 3777  
hello@smileymonroe.com  
**smileymonroe.com**

### **OFFICE & PRODUCTION CENTRE US**

**Smiley Monroe Inc**  
205 North St  
Franklin  
KY 42134

+270 253 8001  
enquires.us@smileymonroe.com  
**smileymonroe.com**

### **OFFICE & PRODUCTION CENTRE INDIA**

**Smiley Monroe Rubber &  
Allied Products (India) Pvt Ltd**  
14/2c Begapali Road  
Anumepalli  
Hosur  
Tamil Nadu - 635126  
India

+91 7397778189  
smindia@smileymonroe.com  
**smileymonroe.com**